



ARIA  
ADURO



Versatility with  
3 diameters

125  
mm

160  
mm

200  
mm

**Insulated mass  
flow ductwork**  
for heat recovery  
ventilation

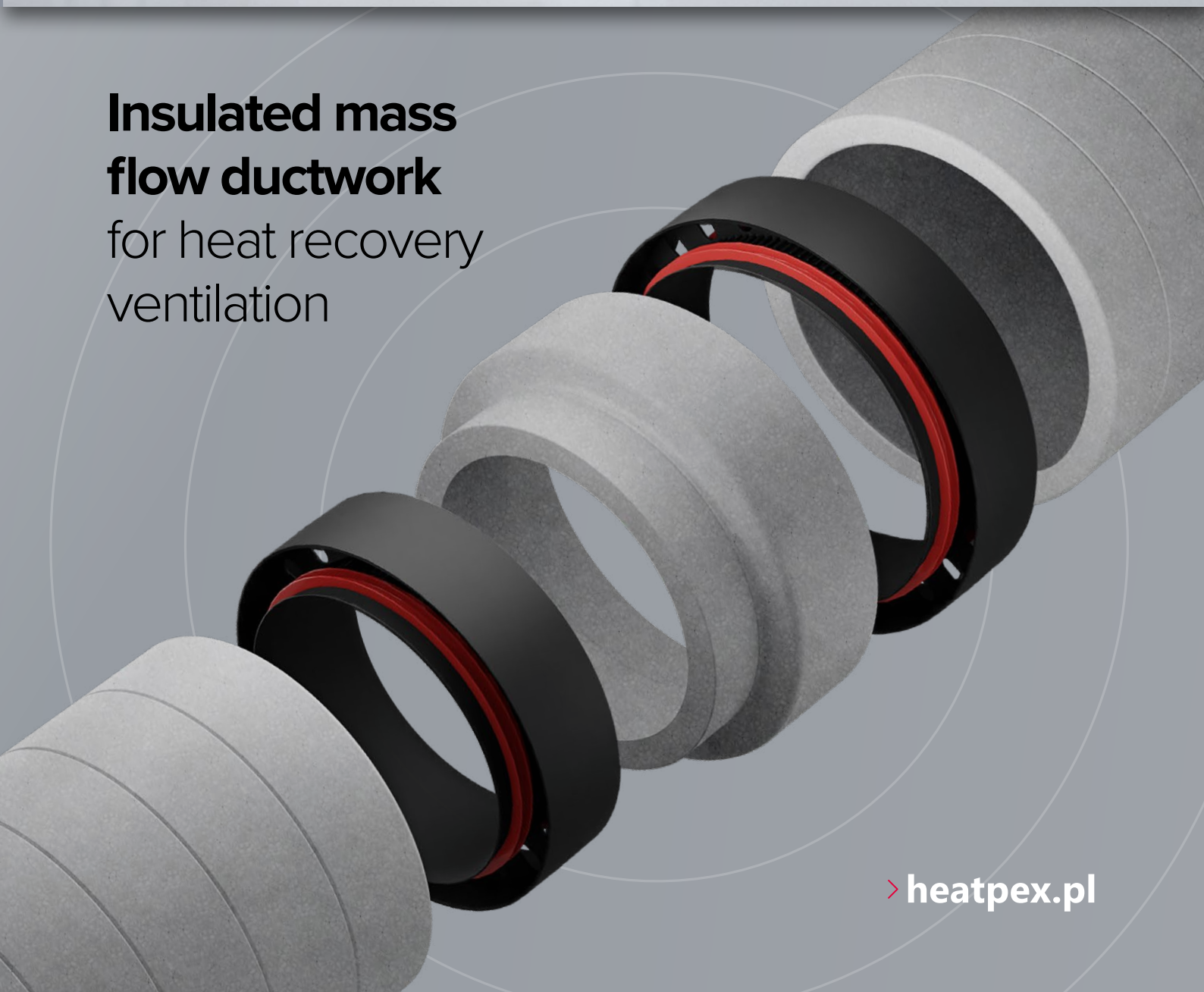

> [heatpex.pl](http://heatpex.pl)

Discover all advantages  
of ARIA ADURO

2 x FASTER  
INSTALLATION

ARIA ADURO is **9 times lighter** than a traditional metal system, making installation much easier



**ONE**  
CLICK  
technology

Proven solution:  
**OneClick technology**

Thanks to the application of OneClick technology known from HEATPEX ARIA air distribution system, **connecting ARIA ADURO elements together is faster and easier than ever before.**

2X LOWER  
AIRFLOW  
RESISTANCE

**compared with flexible ducts:**  
quiet operation and lower maintenance costs



ARIA ADURO system is built from **rigid materials with smooth inner walls**



**No risk of deformation** during assembly – **constant cross-section all along**



**Low noise level**

## Complete system .....

**ARIA ADURO is 100% compatible with HEATPEX ARIA** air distribution semi-rigid ducting system

## Standard dimensions

**ARIA ADURO fits to most heat recovery units available on the market**, its dimensions coherent with traditional ventilation systems. Internal dimensions comply with EN 1506:2007 standards.



# Elements of ARIA ADURO system

ARIA  
ADURO

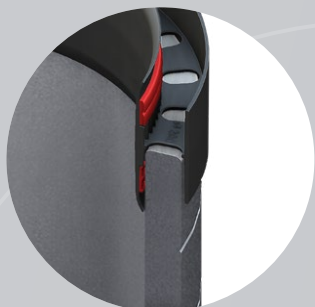

## Connector

Connector (gasket included) – a simple push-fit connection. **Connector low profile does not alter the overall installation diameter.**

Special openings **indicate secure connection.**



Mounting bracket with adjustable band clamp

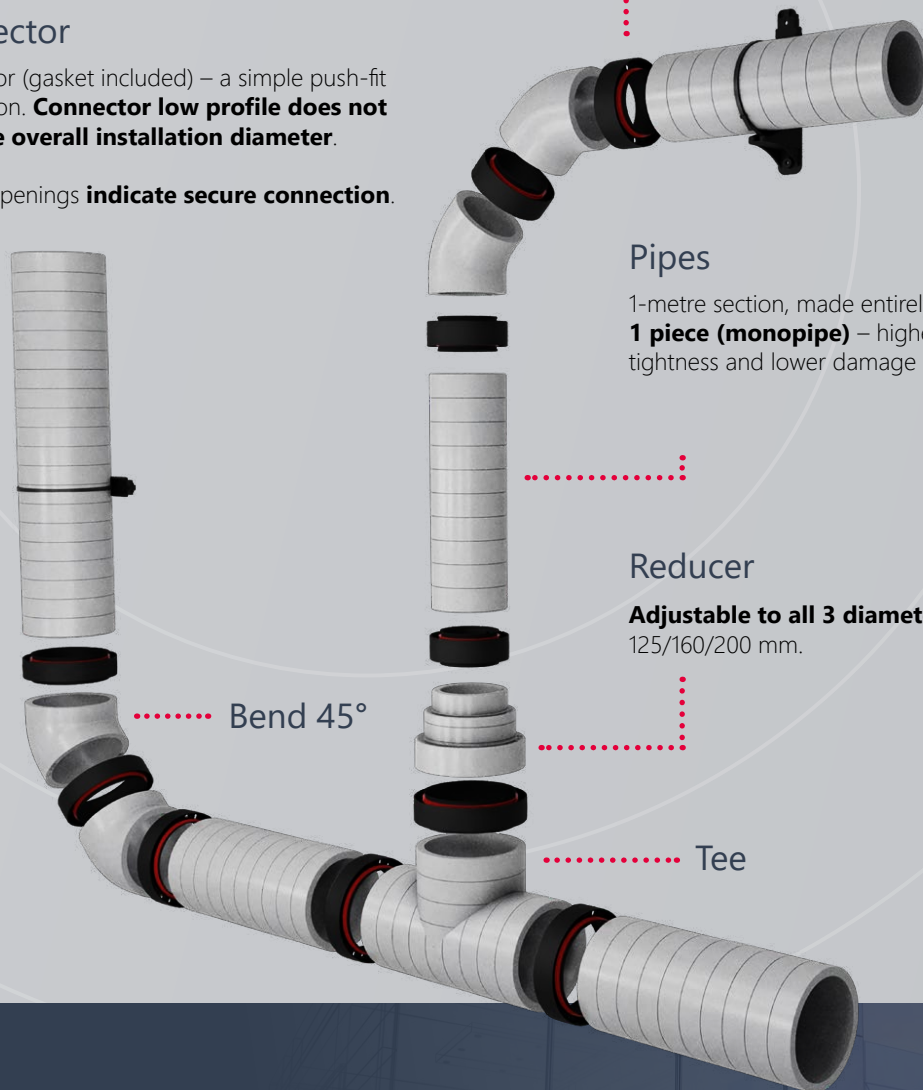

## Pipes

1-metre section, made entirely from **1 piece (monopipe)** – higher tightness and lower damage risk.

## Reducer

**Adjustable to all 3 diameters:**  
125/160/200 mm.

Bend 45°

Tee

## Application of ARIA ADURO

Alternative to spiro pipes.

Transfer of large air flows between:

> air intake, outlet grille and heat recovery unit

**AND**

> heat recovery unit and internal air distribution ducting system

## High insulating properties

### Light, durable and airtight material with excellent insulating properties

(EPS – expanded polystyrene), enriched with graphite – resistant to fungi, mould, and bacteria.

Raw materials used along with added graphite **significantly increase the insulation**

**coefficient:  $\lambda = 0.029$  (W/mK)**, especially when compared to wool-insulated metal pipes.



**125**  
mm

**160**  
mm

**200**  
mm

### Versatile system: 3 diameters

**Reducer adjustable  
to all diameters**



## Original mounting brackets for quick installation

- > **Quick installation** – simply attach the bracket to the surface, slide the pipe through and tighten the band.
- > **Modularity** – brackets, connected in series or in parallel, can be used for routing two or more ducts next to each other.
- > Ultra-light elements **require a minimum number** of mounting brackets.
- > **Versatility** – one size bracket for all 3 diameters.

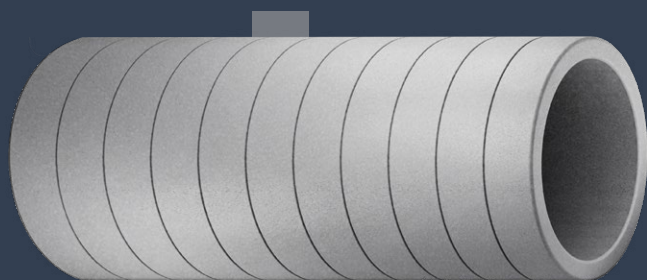

**5 cm**

### Effortless cutting – simple setup

**Markers (every 5 cm)** help cut the pipe to required length. Wall thickness of only 17 mm lets you easily cut the pipe, using a simple knife

## Technical data: **System elements**

Name		Designation	Diameter		Length	Material	Catalogue number
			inner	outer			
			mm	mm	mm		
Pipe 1 m		ADR 125	125	159	1000	EPS	529 125 001
		ADR160	160	194			529 160 001
		ADR 200	200	234			529 200 001
Bend 45°		ADK 125	125	159	213	EPS	529 125 901
		ADK160	160	194	226		529 160 901
		ADK 200	200	234	240		529 200 901
Tee		ADT 125	125	159	380	EPS	529 125 801
		ADT160	160	194			529 160 801
		ADT 200	200	234			529 200 801
Damper		ADP 125	125	159	250	EPS, galvanized steel	529 125 601
		ADP160	160	194			529 160 601
		ADP 200	200	234			529 200 601
Connector		ADL 125	125		70	PP, EPDM	529 125 701
		ADL160	160				529 160 701
		ADL 200	200				529 200 701
Reducer		ADD 125/160/200	125/160/200		167	EPS	520 102 001
Mounting bracket		ADU 125/160/200	125/160/200		300	PP, nylon	520 101 001

## Technical data: **Accessories**

Name		Designation	Diameter	Length	Material	Catalogue number
			mm	mm		
<b>Duct silencer</b>		BL 125	125	1000	Aluminum-polyester jacket, galvanized steel, EPDM gaskets, glass wool insulation	520 103 001
		BL160	160			520 104 001
		BL 200	200			520 105 001
<b>Air intake/outlet grille - hooded</b>		AN 125	125	-	Stainless steel	520 106 001
		AN160	160			520 107 001
		AN 200	200			520 108 001
<b>Air intake/ outlet grille - flat</b>		KA 125	125	-	Stainless steel	520 109 001
		KA160	160			520 110 001
		KA 200	200			520 111 001

# ARIA Planner



**Design a heat recovery system in 10 minutes!**

**ARIA PLANNER – selection software, an easy tool that creates a bill of materials needed for each HRV project.**

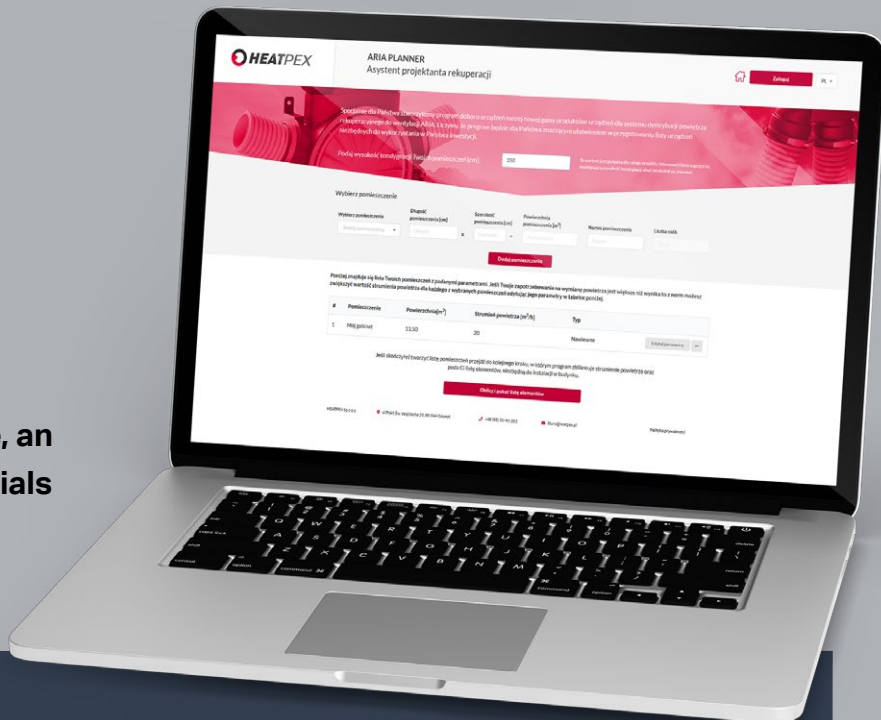

## 3 SIMPLE STEPS

### STEP 1

**Enter the list of rooms from your floorplan**

ARIA PLANNER will **automatically select the size of the heat recovery unit and required air flows** depending on room type and number of occupants.

It will then **create air flow balance** for a harmonised supply and exhaust ventilation system.

ARIA PLANNER will also **determine the number of supply and exhaust points (diffusers) for each room** and calculate the number of required ventilation ducts.

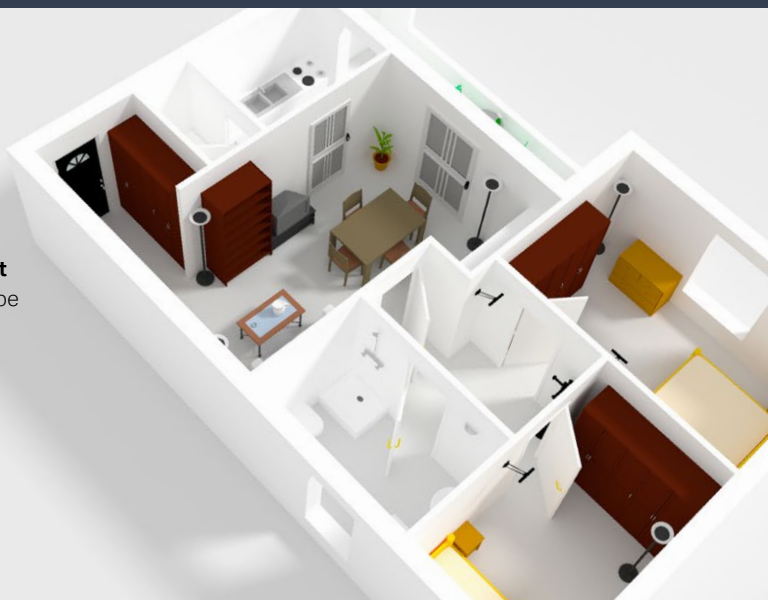

### STEP 2

**Choose the type of connection to heat recovery unit – SIDE or CENTRAL**

**You will receive a list** of components and air supply requirements, all tailored to your home design

Lista materiałów:

Numer katalogowy	Nazwa	Liczba [sztuk]	Cena netto [PLN/szt]	Wartość netto [PLN]
523 375 001	Skrzynia rozprężna	15	104,82	1572,30
523 375 001	Skrzynia rozprężna	15	104,82	1572,30
520 022 001	Anemostat wysięwny 125	8	38,92	311,36
520 022 001	Anemostat wysięwny 125	8	38,92	311,36
520 021 001	Anemostat nawiewny 125	7	41,95	293,65
520 021 001	Anemostat nawiewny 125	7	41,95	293,65
520 075 050	Rura ARIA 75 - zwij 50m	8	375,00	3000,00
520 075 050	Rura ARIA 75 - zwij 50m	8	375,00	3000,00

Cena włączona:

### STEP 3

**Save and download your design**



The design **contains calculated air flows, a bill of materials tailored to the selected configuration** as well as **guidelines on installation of the heat recovery system**. The document will indicate where and how to install diffusers, how to route ventilation ducts, and where to place the air intake and exhaust outlets. \*

ARIA PLANNER IS AVAILABLE ON OUR WEBSITE

**www.heatpex.pl**



**HEATPEX Sp. z o.o.**

ul. Chrzanowskiego 11,  
80-278 Gdańsk, Poland  
mob.: +48 661 693 697  
e-mail: sales@heatpex.pl

> **heatpex.pl**

This brochure, together with the information contained herein, is for informational purposes only and does not constitute an offer as defined in the provisions of the Civil Code. HEATPEX reserves the right to introduce content changes and without prior notice.